

AXLE SHAFT - INSTALLATION

INSTALLATION

1. Clean axle shaft and apply a thin film of gease to the shaft splines and hub bore.
2. Install axle shaft (2) through the steering knuckle (3) and into the differential side gears.

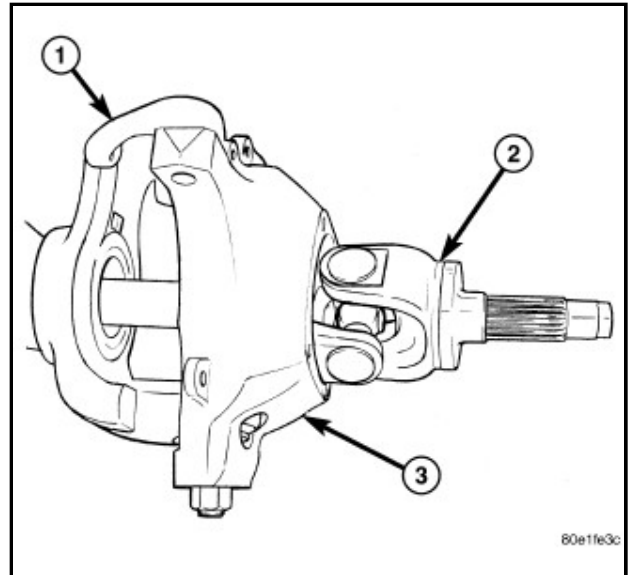

3. Install hub bearing in the knuckle.
4. Install hub bearing bolts (2) and tighten to 202 N·m (149 ft. lbs.).
5. Install ABS wheel speed sensor, brake rotor and caliper.

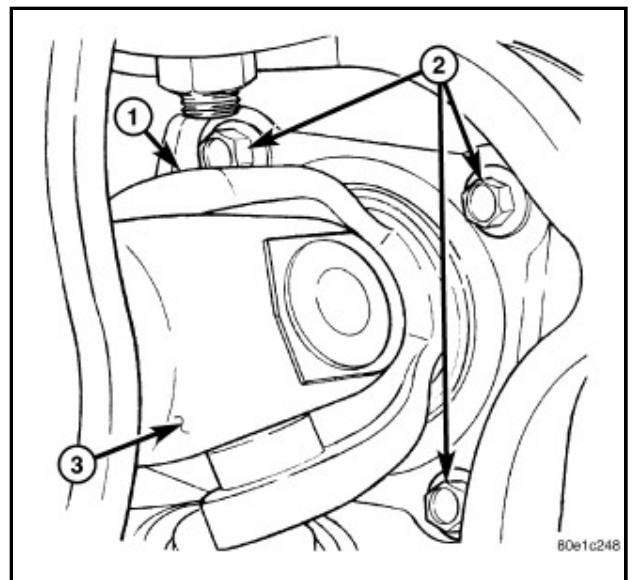

6. Install axle nut (1). Tighten axle nut to 179 N·m (132 ft. lbs.).
7. Rotate axle several 5 to 10 times to seat the wheel bearing.
8. Tighten axle nut (1) to final torque of 356 N·m (263 ft. lbs.).

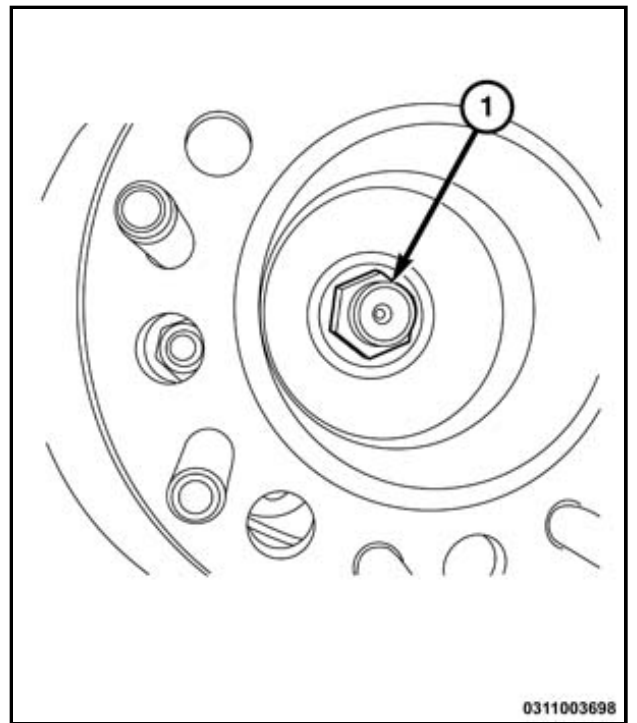

0311003698