

2017 Dodge or Ram Truck RAM 3500 Truck 4WD L6-6.7L DSL Turbo

Vehicle > Powertrain Management > Emission Control Systems > Exhaust Gas Recirculation > Pressure Control Flap > Service and Repair > Removal and Replacement

EXHAUST GAS RECIRCULATION (EGR) AIRFLOW CONTROL VALVE - INSTALLATION (6.7L DSL)

INSTALLATION

1. Clean the mating surfaces at the top of EGR air flow control valve (5) and the bottom of air intake connection (2).
2. Using a new gasket (3) install the EGR air flow control valve (5). Tighten bolts (4 and 6) to 10 N·m (89 in. lbs.).

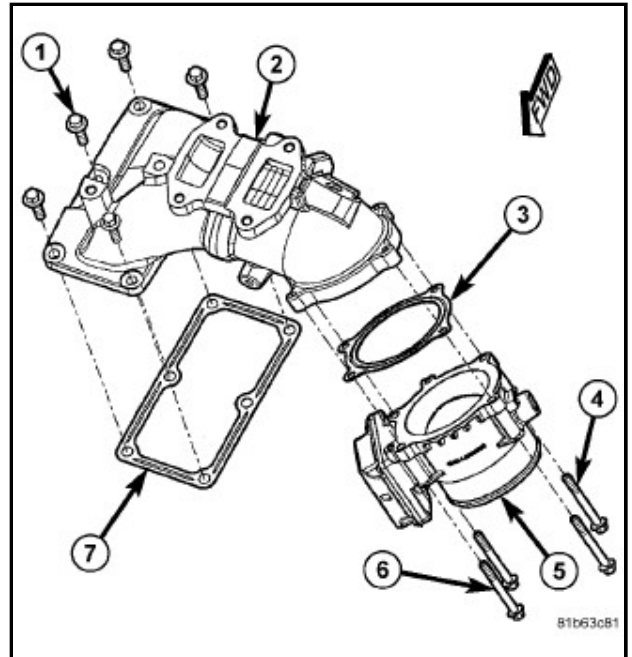

3. Install the EGR control valve heat shield (2). Tighten the fasteners to:
 - Tighten the bolt (3) to 24 N·m (18 ft. lbs.).
 - Tighten the nut to 9 N·m (80 in. lbs.).

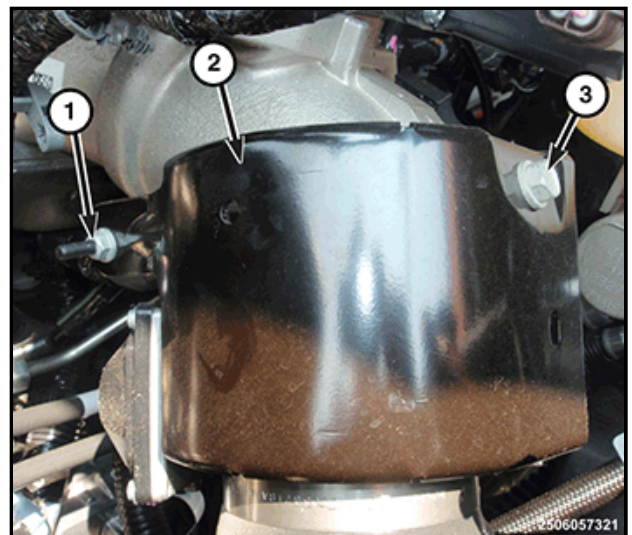

4. Attach the wire harness retainers (1) to the heat shield.

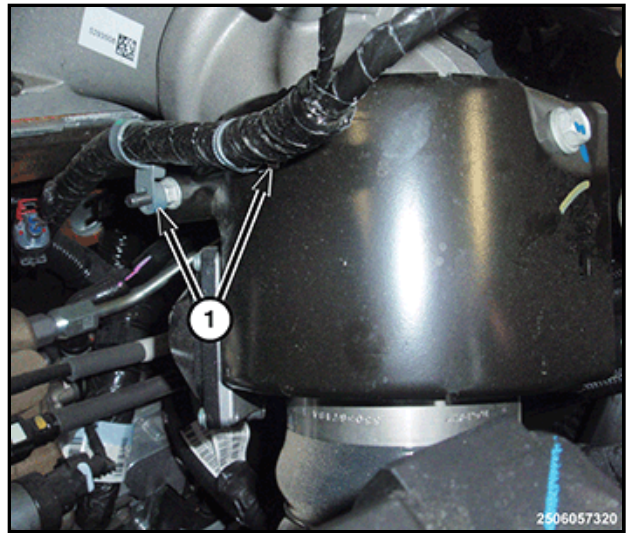

5. Connect the EGR air flow control valve wire harness connector (2).
6. Install the EGR air flow control valve inlet hose (3). Tighten clamps (1) to 14 N·m (10 ft. lbs.).

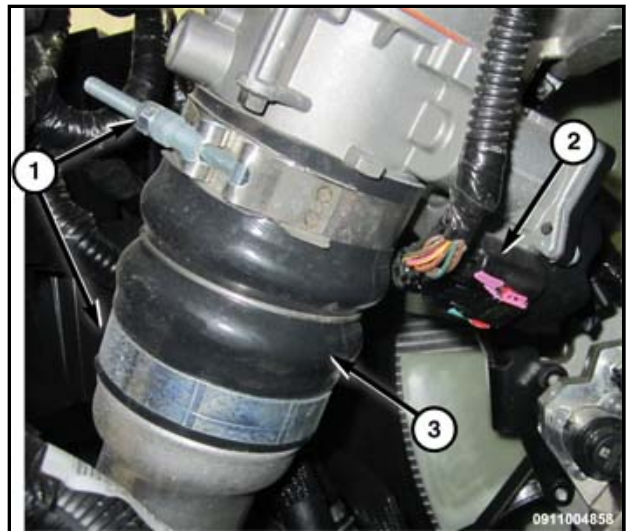

7. Install the engine cover (3).
8. Install the engine oil dipstick (2). Tighten bolts (1) to 10 N·m (89 in. lbs.).
9. Connect both negative battery cables.

