

INSTALLATION INSTRUCTIONS

Insert bolt #4 through Washer #3, Anvil #2 and Screw Rivnut #1 onto Bolt, finger tight.

Insert Complete Assembly #5 into Hex Hole on vehicle until flange of Rivnut is in contact with the surface of the hole.

Hold in place with a 9/16 box end wrench on the Hex Portion of Anvil #2, use a 13MM socket and ratchet to tighten bolt while holding Anvil #2 stationary with wrench.

Tightening of Bolt #4 causes the Rivnut #1 to crimp on the underside of the hex hole. Continue tightening until increased resistance is felt (approximately 3.5 turns).

Caution: Over-tightening of the bolt will cause damage to the thread of the Rivnut and Bolt.

Once Rivnut is installed, turn Bolt # 4 counter clockwise to loosen and remove it from the Rivnut.

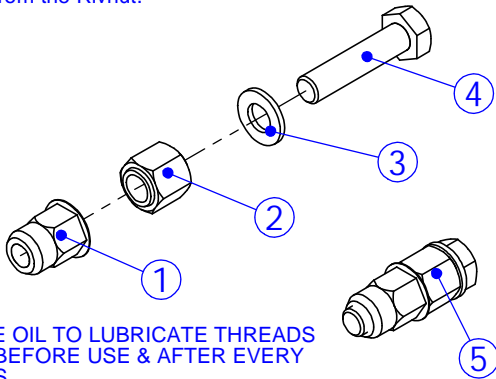

NOTE: USE OIL TO LUBRICATE THREADS OF BOLT BEFORE USE & AFTER EVERY 3 RIVNUTS

BCA 006 015, 09/16/08

INSTALLATION INSTRUCTIONS

Insert bolt #4 through Washer #3, Anvil #2 and Screw Rivnut #1 onto Bolt, finger tight.

Insert Complete Assembly #5 into Hex Hole on vehicle until flange of Rivnut is in contact with the surface of the hole.

Hold in place with a 9/16 box end wrench on the Hex Portion of Anvil #2, use a 13MM socket and ratchet to tighten bolt while holding Anvil #2 stationary with wrench.

Tightening of Bolt #4 causes the Rivnut #1 to crimp on the underside of the hex hole. Continue tightening until increased resistance is felt (approximately 3.5 turns).

Caution: Over-tightening of the bolt will cause damage to the thread of the Rivnut and Bolt.

Once Rivnut is installed, turn Bolt # 4 counter clockwise to loosen and remove it from the Rivnut.

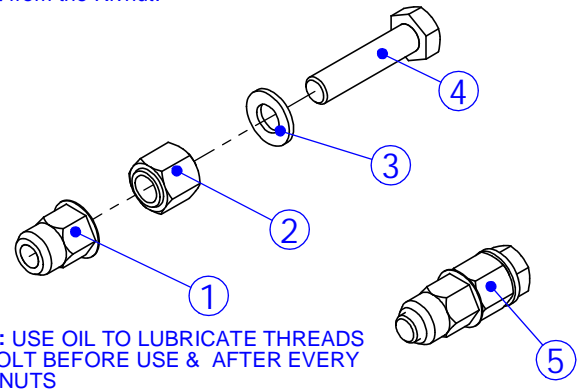

NOTE: USE OIL TO LUBRICATE THREADS OF BOLT BEFORE USE & AFTER EVERY 3 RIVNUTS

BCA 006 015, 09/16/08

INSTALLATION INSTRUCTIONS

Insert bolt #4 through Washer #3, Anvil #2 and Screw Rivnut #1 onto Bolt, finger tight.

Insert Complete Assembly #5 into Hex Hole on vehicle until flange of Rivnut is in contact with the surface of the hole.

Hold in place with a 9/16 box end wrench on the Hex Portion of Anvil #2, use a 13MM socket and ratchet to tighten bolt while holding Anvil #2 stationary with wrench.

Tightening of Bolt #4 causes the Rivnut #1 to crimp on the underside of the hex hole. Continue tightening until increased resistance is felt (approximately 3.5 turns).

Caution: Over-tightening of the bolt will cause damage to the thread of the Rivnut and Bolt.

Once Rivnut is installed, turn Bolt # 4 counter clockwise to loosen and remove it from the Rivnut.

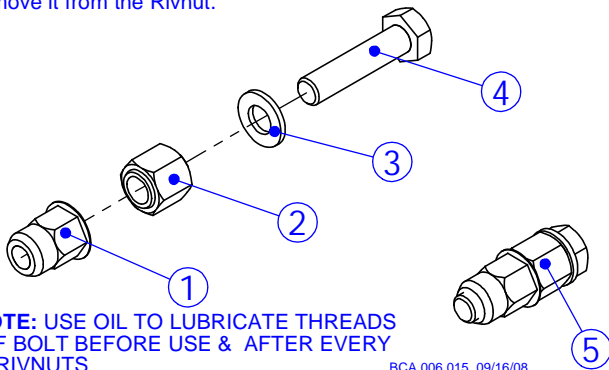

NOTE: USE OIL TO LUBRICATE THREADS OF BOLT BEFORE USE & AFTER EVERY 3 RIVNUTS

BCA 006 015, 09/16/08

INSTALLATION INSTRUCTIONS

Insert bolt #4 through Washer #3, Anvil #2 and Screw Rivnut #1 onto Bolt, finger tight.

Insert Complete Assembly #5 into Hex Hole on vehicle until flange of Rivnut is in contact with the surface of the hole.

Hold in place with a 9/16 box end wrench on the Hex Portion of Anvil #2, use a 13MM socket and ratchet to tighten bolt while holding Anvil #2 stationary with wrench.

Tightening of Bolt #4 causes the Rivnut #1 to crimp on the underside of the hex hole. Continue tightening until increased resistance is felt (approximately 3.5 turns).

Caution: Over-tightening of the bolt will cause damage to the thread of the Rivnut and Bolt.

Once Rivnut is installed, turn Bolt # 4 counter clockwise to loosen and remove it from the Rivnut.

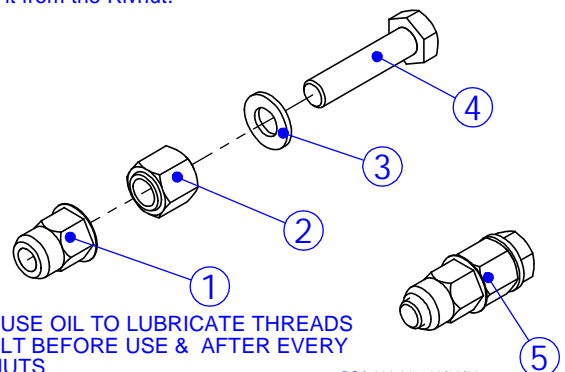

NOTE: USE OIL TO LUBRICATE THREADS OF BOLT BEFORE USE & AFTER EVERY 3 RIVNUTS

BCA 006 015, 09/16/08